

Micro-power Inverting DC/DC Converters in SOT-23-5

Features

- Configurable Output Voltage Up to -30V
- 20 μ A Quiescent Current
- <1 μ A Shutdown Current
- <1 μ A Shutdown Pin Current
- Supply Range from 2.5V to 6.5V
- Low $R_{DS(ON)}$: 0.8 Ω
- Tiny SOT23-5 Package

Applications

- STN/TFT LCD Bias
- Personal Digital Assistants (PDAs)
- Handheld Computers
- Digital Still Cameras
- Cellular Phones
- Web Pad

General Description

The G5122 inverting DC/DC converter is designed for small/ medium size LCD panel of high bias voltage.

Due to a typical 20 μ A quiescent current and 2.5V~6.5V supply voltage range, it is suitable for battery powered portable applications. Such as PDAs and Handheld Computers. When the IC sets to shutdown mode, it only consumes less than 1 μ A.

Furthermore, the 350mA current limit, 500ns fixed minimum off-time and tiny SOT23-5 package facilitates the use of smaller inductor and other surface-mount components to minimize the PCB size in those space-conscious applications.

To control the IC, no other external current is needed for the shutdown pin. It typically consumes less than 1 μ A of full supply range.

Ordering Information

ORDER NUMBER	ORDER NUMBER (Pb free)	MARKING	TEMP. RANGE	PACKAGE
G5122T11U	G5122T11Uf	5122x	-40°C ~ +85°C	SOT-23-5

Pin Configuration

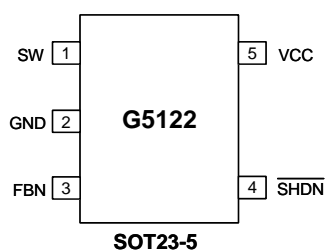

Typical Application Circuit

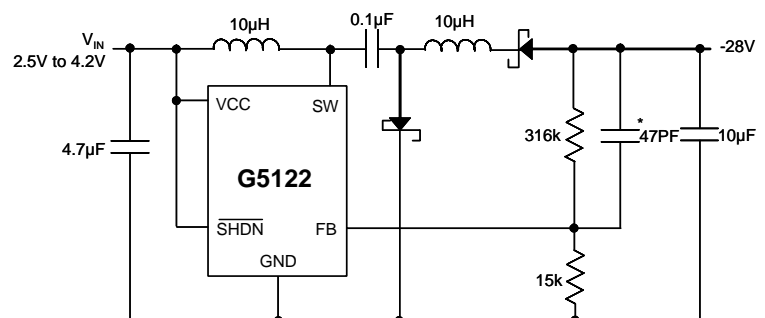

* option

Absolute Maximum Ratings

SW to GND.....	-0.3V to +33V	Junction Temperature	+125°C
FBN to GND.....	-V _{CC} to +0.3V	Storage Temperature.....	-65°C to +150°C
V _{CC} , $\overline{\text{SHDN}}$ to GND.....	-0.3V to +7V	Reflow Temperature (Soldering, 10 sec).....	260°C
Operating Temperature Range (Note 1) ..	-40°C to +85°C		

Stress beyond those listed under "Absolute Maximum Rating" may cause permanent damage to the device.

Electrical Characteristics

(V_{CC} = 3.6V, V_{SHDN} = 3.6V, T_A = 25°C)

PARAMETER	CONDITIONS	MIN	TYP	MAX	UNITS
Input Voltage Range		2.5	---	6.5	V
Quiescent Current	Not Switching	---	20	35	μA
	V _{SHDN} = 0V	---	0.1	1	μA
FBN Comparator Trip Point		-1.18	-1.2	-1.22	V
Output Voltage Line Regulation	2.5V < V _{IN} < 6.5V	---	-0.05	---	%/V
FBN Pin Bias Current (Note 2)	V _{FBN} = -1.2V	---	-1.6	-2.4	μA
Switch Off Time	V _{FBN} < -1V	---	500	---	ns
Switch R _{DS(ON)}	I _{SW} = 150mA	---	0.8	1	Ω
Switch Current Limit		300	350	400	mA
SHDN Pin Current		---	0.1	1	μA
SHDN Input Voltage High		0.9	---	---	V
SHDN Input Voltage Low		---	---	0.25	V
Switch Leakage Current	Switch Off, V _{SW} = 33V	---	0.01	5	μA
Input Voltage UVLO		---	1.9	---	V

Note 1: The G5122 are guaranteed to meet performance specifications from 0°C to 85°C. Specifications over the -40°C to 85°C operating temperature range are assured by design, characterization and correlation with statistical process controls.

Note 2: Bias current flows into the FBN pin.

Block Diagram

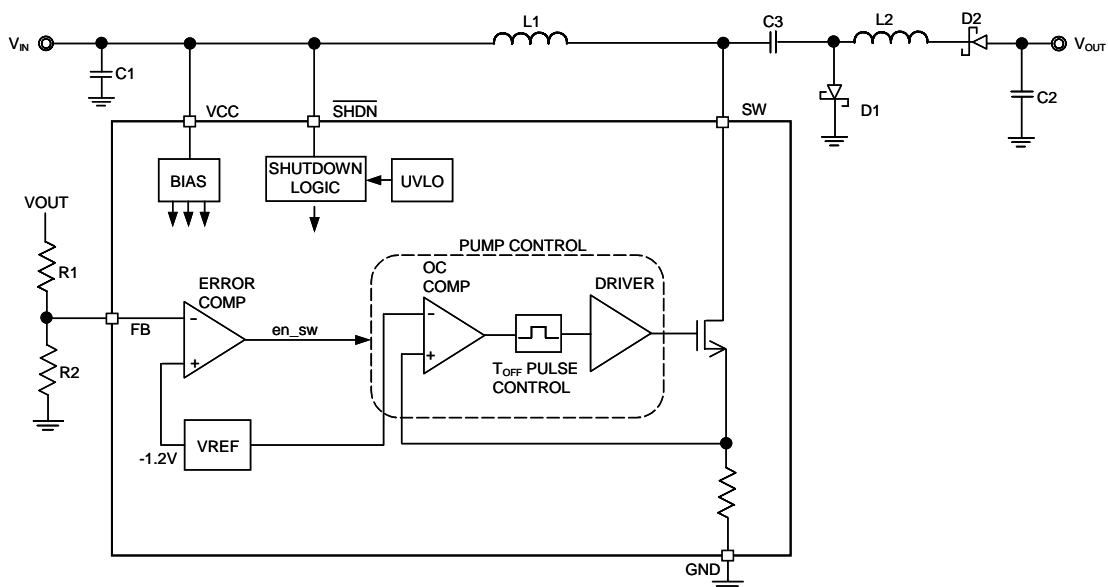

Typical Performance Characteristics

($V_{CC}=+3.6V$, $V_{SHDN} = +3.6V$, $L=10\mu H$, $T_A=25^\circ C$, unless otherwise noted.)

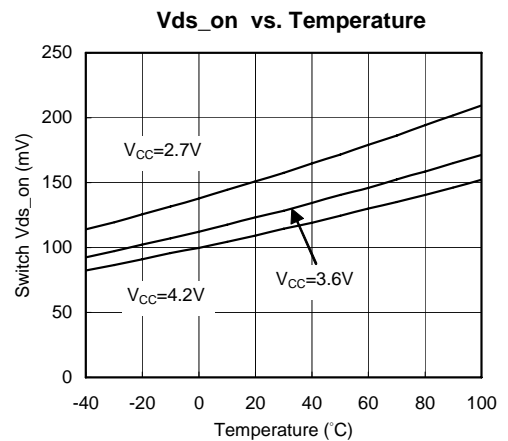
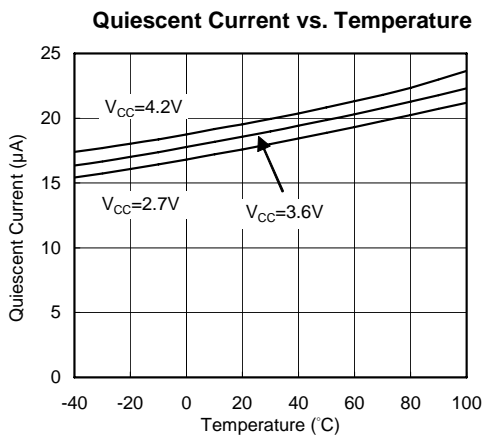
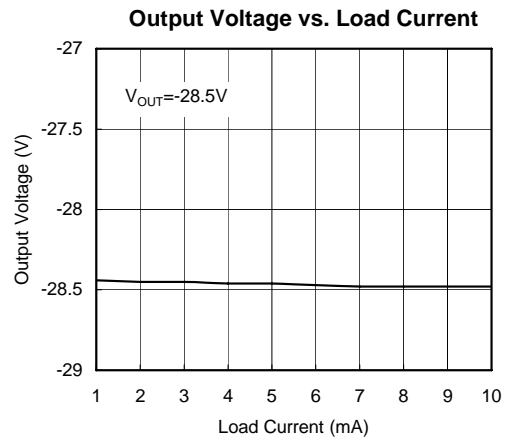
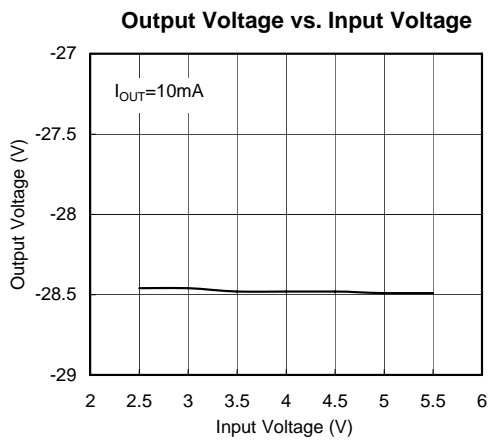
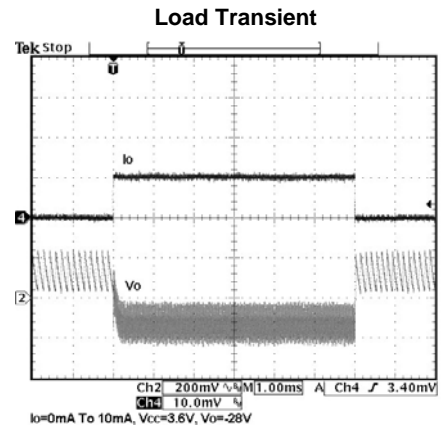
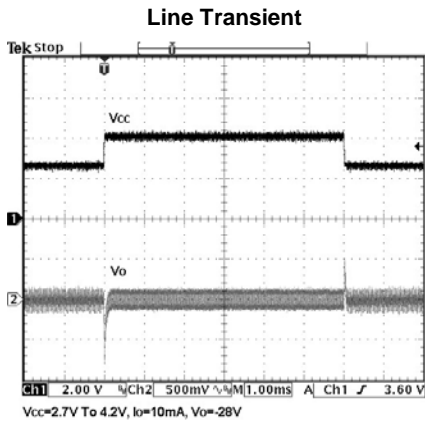

Typical Performance Characteristics (Continued)

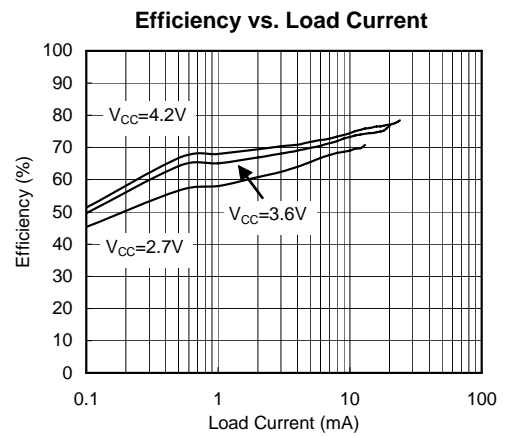
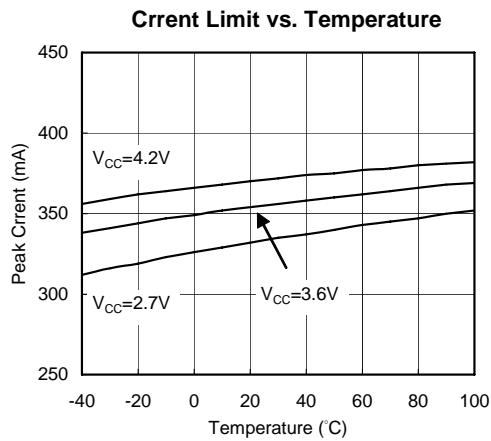
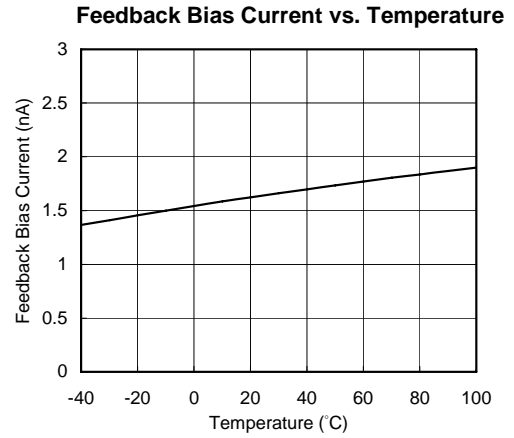
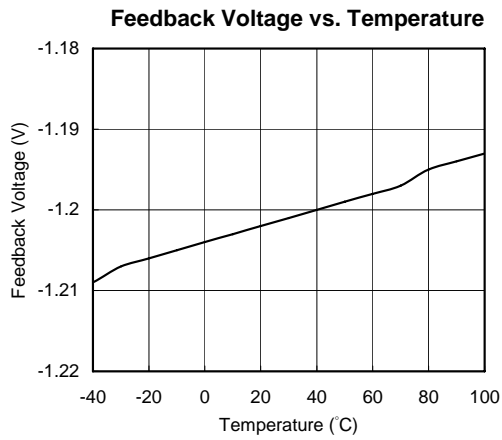

Recommended Minimum Footprint

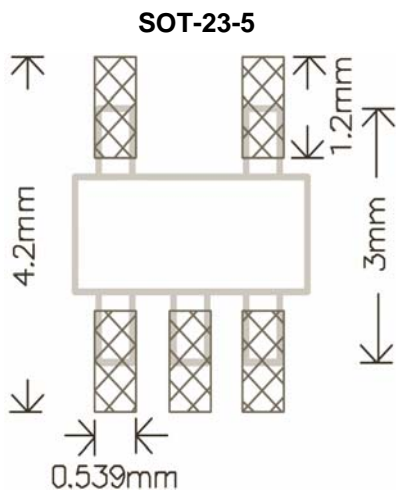

**Pin Description**

PIN	NAME	FUNCTION
1	SW	Switch Pin. The drain of the internal NMOS power switch. Connect this pin to inductor.
2	GND	Ground.
3	FBN	Feedback Pin. Set the output voltage by selecting values for R1 and R2 (see Block Diagram): $R1 = \frac{ V_{OUT} - 1.2}{1.2/R2 + (1.6 \times 10^{-6})}$
4	SHDN	Active-Low Shutdown Pin. Tie this pin to logic-high to enable the device or tied it to logic-low to turn this device off.
5	VCC	Input Supply Pin. Bypass this pin with a capacitor as close to the device as possible.

Package Information

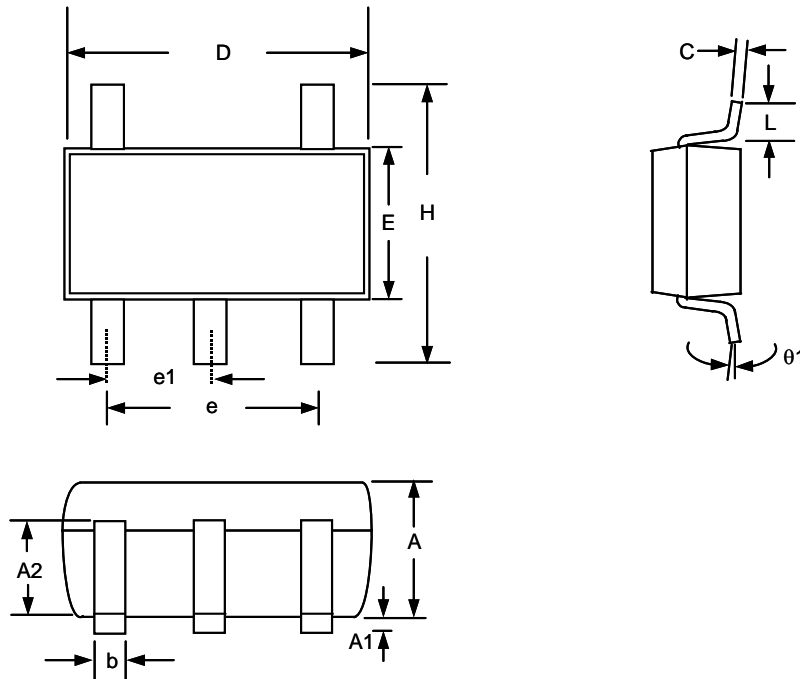

Note:

1. Package body sizes exclude mold flash protrusions or gate burrs
2. Tolerance ± 0.1000 mm (4mil) unless otherwise specified
3. Coplanarity: 0.1000mm
4. Dimension L is measured in gage plane

SYMBOLS	DIMENSIONS IN MILLIMETERS		
	MIN	NOM	MAX
A	1.00	1.10	1.30
A1	0.00	-----	0.10
A2	0.70	0.80	0.90
b	0.35	0.40	0.50
C	0.10	0.15	0.25
D	2.70	2.90	3.10
E	1.40	1.60	1.80
e	-----	1.90(TYP)	-----
e1	-----	0.95	-----
H	2.60	2.80	3.00
L	0.37	-----	-----
$\theta 1$	1°	5°	9°

Taping Specification

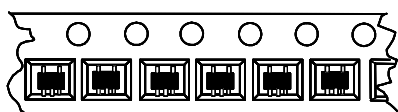

SOT-23-5 Package Orientation

PACKAGE	Q'TY/REEL
SOT-23-5	3,000 ea

GMT Inc. does not assume any responsibility for use of any circuitry described, no circuit patent licenses are implied and GMT Inc. reserves the right at any time without notice to change said circuitry and specifications.