

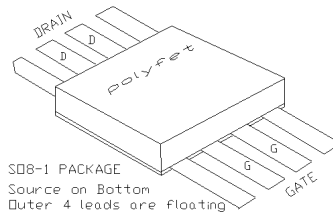

General Description

Silicon VDMOS and LDMOS transistors designed specifically for broadband RF applications. Suitable for Military Radios, Cellular and Paging Amplifier Base Stations, Broadcast FM/AM, MRI, Laser Driver and others.



SILICON GATE ENHANCEMENT MODE

RF POWER LDMOS TRANSISTOR

15.0 Watts Single Ended

Package Style SO8 -1

**HIGH EFFICIENCY, LINEAR
HIGH GAIN, LOW NOISE**

"Polyfet"TM process features low feedback and output capacitances resulting in high F_t transistors with high input impedance and high efficiency.

ABSOLUTE MAXIMUM RATINGS (T = 25 °C)

Total Device Dissipation	Junction to Case Thermal Resistance	Maximum Junction Temperature	Storage Temperature	DC Drain Current	Drain to Gate Voltage	Drain to Source Voltage	Gate to Source Voltage
50 Watts	3.40 °C/W	200 °C	-65 °C to 150 °C	3.0 A	70V	70V	20 V

RF CHARACTERISTICS (15.0 WATTS OUTPUT)

SYMBOL	PARAMETER	MIN	TYP	MAX	UNITS	TEST CONDITIONS
Gps	Common Source Power Gain	12			dB	$I_{dq} = 0.40 \text{ A}$, $V_{ds} = 28.0 \text{ V}$, $F = 1,000 \text{ MHz}$
η	Drain Efficiency		55		%	$I_{dq} = 0.40 \text{ A}$, $V_{ds} = 28.0 \text{ V}$, $F = 1,000 \text{ MHz}$
VSWR	Load Mismatch Tolerance			20:1	Relative	$I_{dq} = 0.40 \text{ A}$, $V_{ds} = 28.0 \text{ V}$, $F = 1,000 \text{ MHz}$

ELECTRICAL CHARACTERISTICS (EACH SIDE)

SYMBOL	PARAMETER	MIN	TYP	MAX	UNITS	TEST CONDITIONS
Bvdss	Drain Breakdown Voltage	65			V	$I_{ds} = 0.10 \text{ mA}$, $V_{gs} = 0\text{V}$
Idss	Zero Bias Drain Current			1.0	mA	$V_{ds} = 28.0 \text{ V}$, $V_{gs} = 0\text{V}$
Igss	Gate Leakage Current			1	uA	$V_{ds} = 0\text{V}$ $V_{gs} = 30\text{V}$
Vgs	Gate Bias for Drain Current	1		7	V	$I_{ds} = 0.10 \text{ A}$, $V_{gs} = V_{ds}$
gM	Forward Transconductance		0.8		Mho	$V_{ds} = 10\text{V}$, $V_{gs} = 5\text{V}$
Rdson	Saturation Resistance		0.90		Ohm	$V_{gs} = 20\text{V}$, $I_{ds} = 2.50 \text{ A}$
I _{dsat}	Saturation Current		5.50		Amp	$V_{gs} = 20\text{V}$, $V_{ds} = 10\text{V}$
Ciss	Common Source Input Capacitance		30.0		pF	$V_{ds} = 28.0 \text{ V}$ $V_{gs} = 0\text{V}$, $F = 1 \text{ MHz}$
Crss	Common Source Feedback Capacitance		1.0		pF	$V_{ds} = 28.0 \text{ V}$ $V_{gs} = 0\text{V}$, $F = 1 \text{ MHz}$
Coss	Common Source Output Capacitance		15.0		pF	$V_{ds} = 28.0 \text{ V}$ $V_{gs} = 0\text{V}$, $F = 1 \text{ MHz}$

L125

POUT VS PIN GRAPH

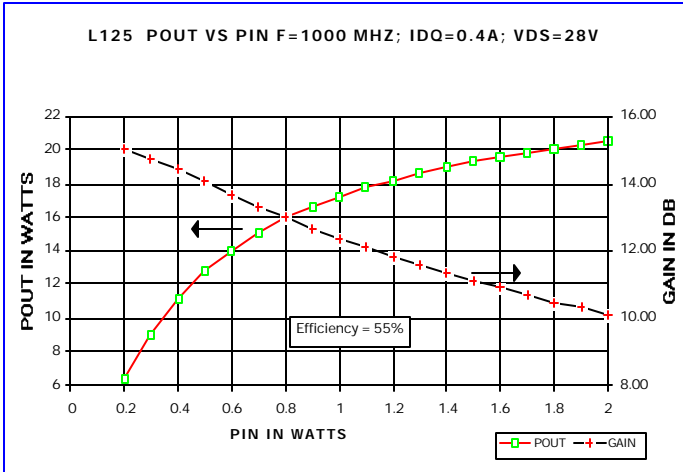

CAPACITANCE VS VOLTAGE

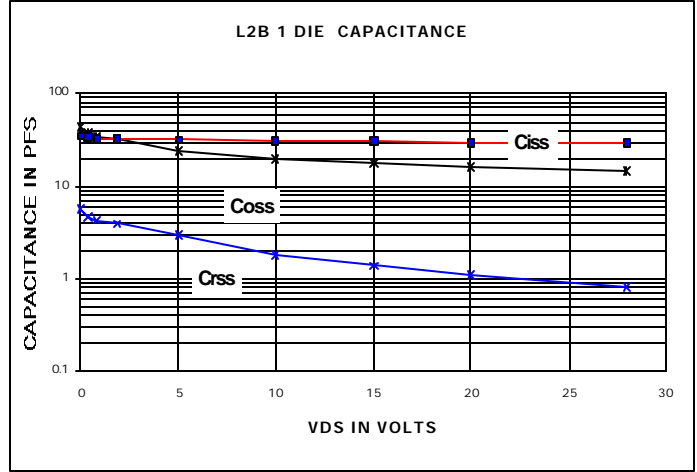

IV CURVE

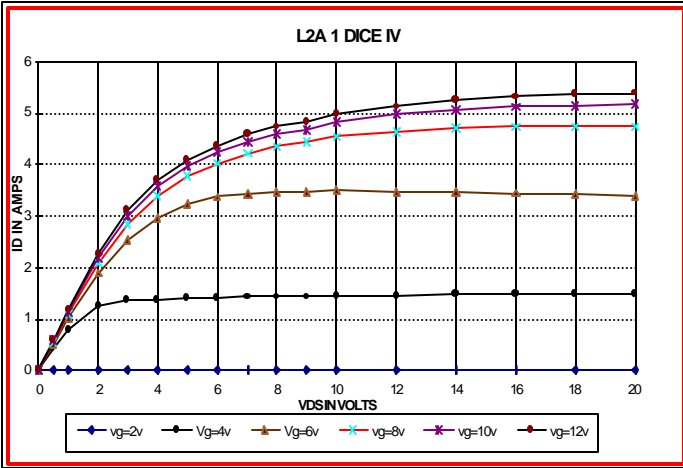

ID & GM VS VGS

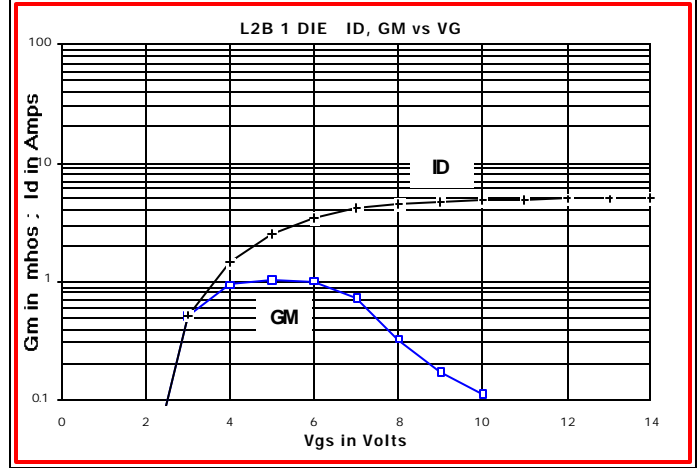

S11 & S22 SMITH CHART

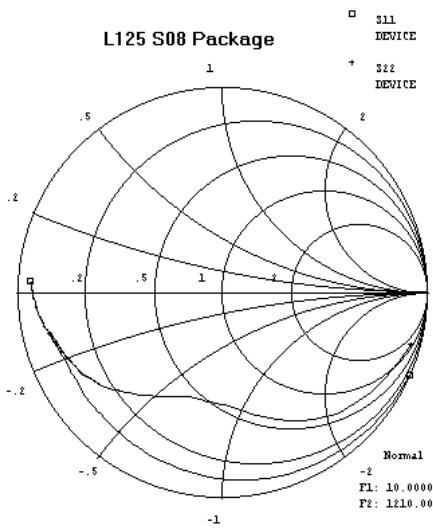

PACKAGE DIMENSIONS IN INCHES

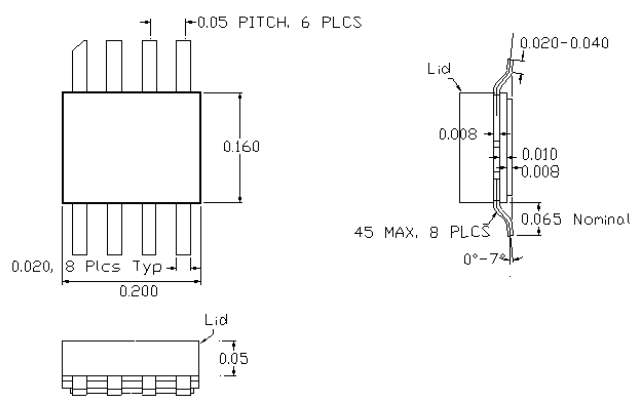

S08 / S08 -1

Tolerance .XX +/-0.01 .XXX +/- .005 inches

POLYFET RF DEVICES

REVISION 03/08/2001

1110 Avenida Acaso, Camarillo, Ca 93012 Tel:(805) 484-4210 FAX: (805) 484-3393 EMAIL:Sales@polyfet.com URL:www.polyfet.com